

SSH REPAIR PARTS

Effective January, 2008

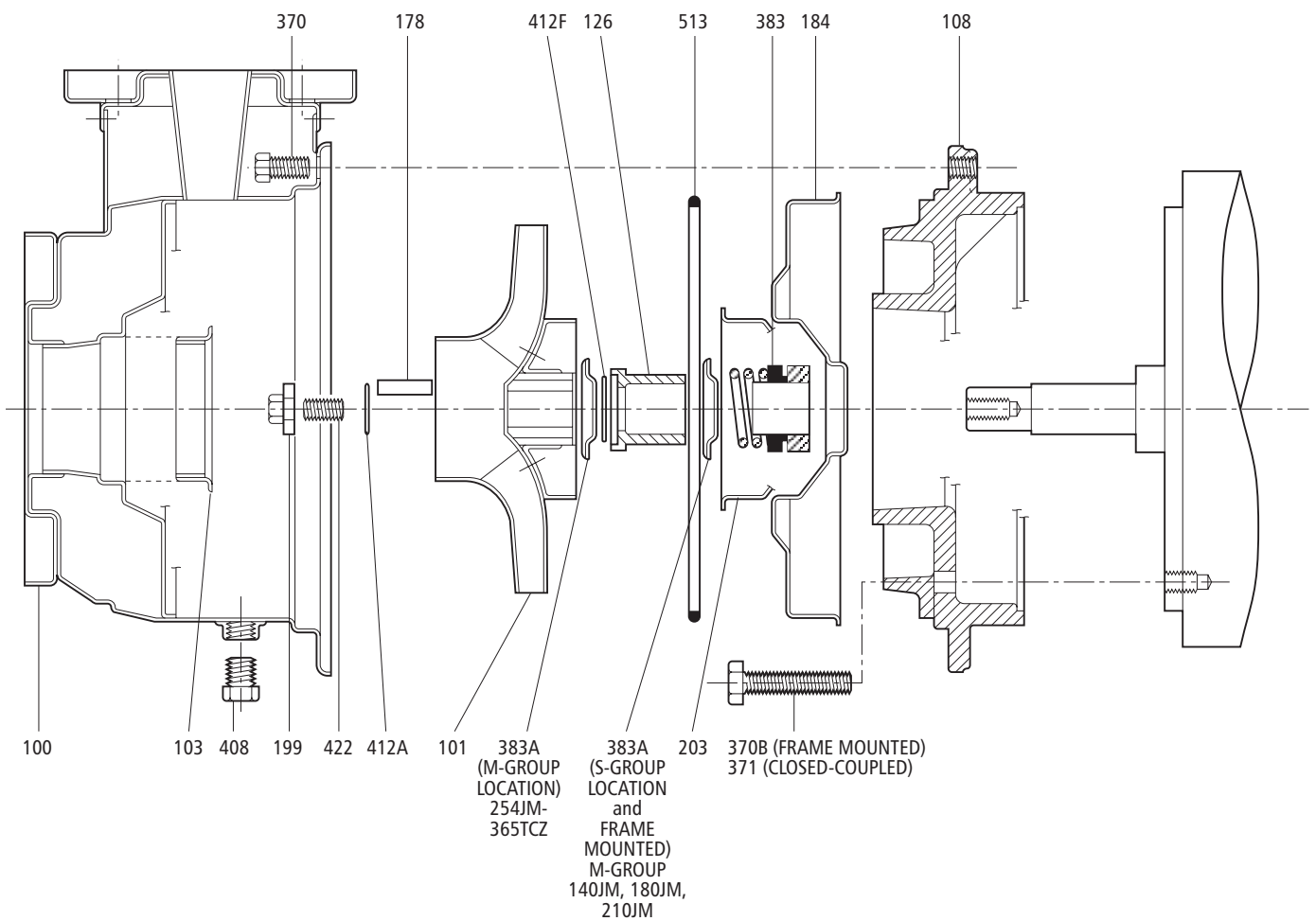

SSH S-GROUP

Item No.	Part Description	Material	1 x 2-6		1½ x 2½-6		2 X 2½-6		2½ x 3-6		1 x 2-8		1½ x 2½-8		2 x 2½-8		1 x 2-10		Max. Wt. (lbs.)		
			①		②		4SH	5SH	6SH	①		7SH	8SH	①							
			9SH 9A-SH	9SH Before Jan. 2003	10SH 10A-SH	10SH Before Jan. 2003				11SH 11-SH	11SH Before Jan. 2003										
100	Casing with wear ring		1L450		1L453		1L456		1L459		1L451		1L454		1L457		1L452		17		
101	Impeller	AISI Type 316SS	6⅞	2L889	2L856	6¾	2L876	6⅞	2L766	7⅞	2L771	8⅞	2L898		8¼	2L879	8¼	2L770	10⅞	2L897	2L865
			6⅞	2L888	2L733	6¾	2L874	6⅞	2L765	7⅞	2L772	8⅞	2L893	2L861	7⅞	2L756	7¾	2L769	9⅞	2L896	2L742
			5⅞	2L887	2L853	6⅞	2L872	5⅞	2L763	6⅞	2L773	7⅞	2L892	2L859	7	2L877	7½	2L768	9⅞	2L895	2L863
			5⅞	2L886	2L730	5⅞	2L871	5½	2L882	6⅞	2L774	7⅞	2L891	2L858	6¾	2L876	7⅞	2L767	8¼	2L894	2L862
						5⅞	2L870	5⅞	2L881	6⅞	2L775	7⅞	2L890	2L735	6⅞	2L875	6⅞	2L766			
						4⅞	2L869	4⅞	2L880	6⅞	2L776				6⅞	2L751	6⅞	2L764			
						4⅞	2L868	4⅞	2L759	5⅞	2L777										
			4⅞	2L867																	
103	Wear ring, casing		4L465		4L466		4L467		4L468		4L465		4L466		4L467		4L465		1		
184	Seal housing with ring		1L465		1L469		1L472		1L466		1L470		1L467						3		
203	Wear ring, seal housing		4L201		4L464		4L201		4L201		4L201		4L201		4L201		4L201				
126	Shaft sleeve	316SS	4L473		4L456		4L473		4L456		4L473		4L456		4L473		4L456				
178	Key, impeller	Steel	4K11		4K11		4K555		4K11		4K555		4K11		4K555		4K11		1		
422	Stud, impeller		13K217		13K217		13K217		13K217		13K217		13K217		13K217		13K217				
199	Washer, impeller	316SS	4L458		4L458		4L458		4L458		4L458		4L458		4L458		4L458				
108	Motor adapter, 143-184JM and S-group brg. frame	Cast iron ASTM A48	1L554		1L50		1L99		1L560		1L52		1L99		1L562		1L97		25		
	Motor adapter, 213-256JM	d. 20	1L555		1L51		1L98		1L561		1L53		1L98		1L563		1L96		29		
370	Bolt, casing	300SS	13L38 (8 req.)		13L89		13L38 (8 req.)		13L89		13L38 (8 req.)		13L89 (8 req.)		13L89 (8 req.)		13L89 (8 req.)		—		
371 or 370B	Bolt, adapter, 143-184JM and S-Group brg. frame	Steel SAE 1200	13K360		13L43		13L43		13K360		13L43		13L43		13K360		13L43		25		
	Bolt, adapter, 213-256JM		13K379		13L41		13K245		13K361		13L40		13K245		13K361		13L40		29		
383	Mech. seal – standard	Type 21	10K27 – carbon/silicon-carbide/viton		10K27 – carbon/silicon-carbide/viton		10K27 – carbon/silicon-carbide/viton		10K27 – carbon/silicon-carbide/viton		10K27 – carbon/silicon-carbide/viton		10K27 – carbon/silicon-carbide/viton		10K27 – carbon/silicon-carbide/viton		10K27 – carbon/silicon-carbide/viton		1		
	Mech. seal – high temp.		10K19 – Carbon/silicon-carbide/EPR		10K19 – Carbon/silicon-carbide/EPR		10K19 – Carbon/silicon-carbide/EPR		10K19 – Carbon/silicon-carbide/EPR		10K19 – Carbon/silicon-carbide/EPR		10K19 – Carbon/silicon-carbide/EPR		10K19 – Carbon/silicon-carbide/EPR		10K19 – Carbon/silicon-carbide/EPR				
	Mech. seal – severe duty		10K64 – Silicon-carbide/silicon-carbide/viton		10K64 – Silicon-carbide/silicon-carbide/viton		10K64 – Silicon-carbide/silicon-carbide/viton		10K64 – Silicon-carbide/silicon-carbide/viton		10K64 – Silicon-carbide/silicon-carbide/viton		10K64 – Silicon-carbide/silicon-carbide/viton		10K64 – Silicon-carbide/silicon-carbide/viton		10K64 – Silicon-carbide/silicon-carbide/viton				
383A	Retainer, seal spring	316SS	4K517		4K517		4K517		4K517		4K517		4K517		4K517		4K517				
408	Plug, vent and drain	316SS	6L60		6L60		6L60		6L60		6L60		6L60		6L60		6L60		2		
412A	O-ring, impeller washer	Viton	5K320 standard (5K195 EPR option)		5K320 standard (5K195 EPR option)		5K320 standard (5K195 EPR option)		5K320 standard (5K195 EPR option)		5K320 standard (5K195 EPR option)		5K320 standard (5K195 EPR option)		5K320 standard (5K195 EPR option)		5K320 standard (5K195 EPR option)		1		
412F	O-ring, shaft sleeve	Viton	5K307 standard (5K306 EPR option)		5K307 standard (5K306 EPR option)		5K307 standard (5K306 EPR option)		5K307 standard (5K306 EPR option)		5K307 standard (5K306 EPR option)		5K307 standard (5K306 EPR option)		5K307 standard (5K306 EPR option)		5K307 standard (5K306 EPR option)				
513	O-ring, casing – standard	Viton	5K407		5L70		5K408		5L70		5L71		5L71		5L71		5L71				
	O-ring, casing – optional	EPR	5K393		5K317		5K394		5K317		5K317		5L110		5L110		5L110				

① 9SH, 10SH and the 11SH units were obsoleted in January 2003 and replaced by the 9ASH, 10ASH and 11ASH units.

② New numbering system on September of 2006 dropped the "A". There was no mechanical change.

SSH M-GROUP (254JM-365TCZ)

Item No.	Part Description	Material	1½ x 2½-10 24SH	2 x 2½-10 25SH	2½ x 3-8 22SH	2½ x 3-10 27SH	3 x 4-8 23SH	3 x 4-10 28SH	Max. Wt. (lbs.)						
100	Casing, with wear ring	AISI Type 316L SS	1L455		1L458		1L460		1L461		1L463		1L464		17
101	Impeller		9 ⁷ / ₈	2L778	9 ⁷ / ₈	2L790	9 ⁷ / ₈	2L808	10 ³ / ₈	2L804	9 ⁷ / ₈	2L825	10 ³ / ₈	2L836	8
			9 ¹ / ₂	2L779	9 ¹ / ₂	2L791	8 ³ / ₄	2L809	9 ¹ / ₂	2L805	8 ¹ / ₂	2L826	10 ¹ / ₄	2L837	
			9 ⁹ / ₁₆	2L780	9 ⁹ / ₁₆	2L792	8 ¹ / ₂	2L810	9 ⁹ / ₁₆	2L806	8 ⁷ / ₁₆	2L827	9 ¹³ / ₁₆	2L838	
			8 ⁷ / ₈	2L781	8 ¹³ / ₁₆	2L793	8 ¹ / ₄	2L811	9 ¹ / ₄	2L807	8 ⁷ / ₁₆	2L828	9 ⁷ / ₁₆	2L839	
			8 ⁸ / ₁₆	2L782	8 ³ / ₁₆	2L794	7 ⁷ / ₈	2L812	8 ³ / ₄	2L809	7 ¹ / ₁₆	2L829	9 ⁹ / ₁₆	2L825	
			8 ¹ / ₄	2L783	7 ¹⁵ / ₁₆	2L795	7 ¹ / ₂	2L813			7 ¹ / ₂	2L830	8 ¹ / ₁₆	2L826	
					7 ¹ / ₁₆	2L796	7 ⁷ / ₈	2L814			7 ⁷ / ₈	2L831			
							6 ¹ / ₁₆	2L815			6 ⁷ / ₈	2L832			
							6 ¹ / ₂	2L816			6 ¹ / ₂	2L833			
									6	2L834					
								5 ¹ / ₂	2L835						
103	Wear ring, casing		4L467			4L468			4L469			1			
184	Seal housing, with ring		1L468			1L473	1L475	1L477	1L478	3					
203	Wear ring, seal housing		4L201			4L464						1			
126	Shaft sleeve	316 SS	4L457												
178	Key, impeller	Steel	4K261												
422	Stud, impeller		13K301												
199	Washer, impeller	316 SS	4L463												
108	Motor adapter, 254-256JM and M-Group bearing frame	Cast iron ASTM A48 cl. 20	1L91		1L89		1L93		1L94		31				
	Motor adapter, 280JM-365TCZ		1L90		1L88		1L92		1L95		44				
370	Bolt, casing	300 SS	13L86 (6 req'd)		13L89 (8 req'd)		13L86 (8 req'd)		13K45 (8 req'd)		–				
371 or 370B	Bolt, adapter, 254-256JM and S-Group bearing frame	Steel SAE 1200	13L88				13L116				–				
	Bolt, adapter, 280JM-365TCZ		13L87				13L115				–				
383	Mech. seal – standard	Type 21	10K45 – carbon/silicon-carbide/viton									1			
	Mech. seal – high temp.		10K20 – Carbon/silicon-carbide/EPR												
	Mech. seal – severe duty		10K65 – Silicon-carbide/silicon-carbide/viton												
383A	Retainer, seal spring	316SS	4K500												
408	Plug, vent and drain	316SS	6L60									2			
412A	O-ring, impeller washer	Viton	5K309 standard (5K308 EPR option)									1			
412F	O-ring, shaft sleeve	Viton	5K309 standard (5K308 EPR option)												
513	O-ring, casing – standard	Viton	5L71		5L70		5L71		5L72						
	O-ring, casing – optional	EPR	5L110		5K317		5L110		5L116						

SSH M-GROUP (140JM, 180JM & 210JM)

Item No.	Part Description	Material	1½ x 2½-10 24SH	2 x 2½-10 25SH	2½ x 3-8 22SH	2½ x 3-10 27SH	3 x 4-8 23SH	Max. Wt. (lbs.)					
100	Casing, with wear ring	AISI Type 316L SS	1L455		1L458		1L460		1L461		1L463		17
101	Impeller		9/8	2L784	9/8	2L797	9/16	2L820	9 15/16	2L817	9/16	2L840	8
			9/2	2L785	9/2	2L798	8 1/2	2L822	9 9/16	2L818	8 1/16	2L841	
			9 3/16	2L786	9 3/8	2L799	8 3/4	2L823	9 1/4	2L819	8 1/16	2L842	
			8 7/8	2L787	8 13/16	2L800	7 7/8	2L824	8 3/4	2L821	7 1/2	2L843	
			8 9/16	2L788	8 3/16	2L801	7 7/8	2L772			7 7/8	2L844	
			8 1/4	2L789	7 15/16	2L802	6 11/16	2L774			6 1/2	2L845	
					7 1/16	2L803					6	2L846	
									5 1/2	2L847			
103	Wear ring, casing			4L467			4L468			4L469			1
184	Seal housing, with ring		1L467			1L472		1L474		1L476		3	
203	Wear ring, seal housing		4L201			4L464						1	
126	Shaft sleeve	316SS	4K501			4L456							
178	Key, impeller	Steel	4K11										
422	Stud, impeller		13K217										
199	Washer, impeller	316 SS	4L458										
108	Motor adapter, 143-184JM and S-group bearing frame	Cast iron ASTM	1L97			1L99		N/A		1L123		25	
	Motor adapter, 213-256JM	A48 cl.20	1L96			1L98		1L100				29	
370	Bolt, casing	300 SS	13L86 (8 req'd)			13L89 (8 req'd)		13L86 (8 req'd)				–	
371 or 370B	Bolt, adapter, 143-184JM and S-group bearing frame	Steel SAE 1200	13L43				N/A		13L117			–	
	Bolt, adapter, 213-256JM		13K245				13K44				–		
383	Mechanical seal – standard	Type 21	10K27 – carbon/silicon-carbide/viton									1	
	Mechanical seal – high temp.		10K19 – Carbon/silicon-carbide/EPR										
	Mechanical seal – severe duty		10K64 – Silicon-carbide/silicon-carbide/viton										
383A	Retainer, seal spring	316 SS	4K517									2	
408	Plug, vent and drain	316 SS	6L60										
412A	O-ring, impeller washer	Viton	5K320 standard (5K195 EPR option)									1	
412F	O-ring, shaft sleeve	Viton	5K320 standard (5K195 EPR)			5K307 standard (5K306 EPR option)							
513	O-ring, casing – standard	Viton	5L71			5L70		5L71					
	O-ring, casing – optional	EPR	5L110			5K317		5L110					